

A modern office lounge with a blue wall, a brown leather sofa, and a glowing geometric light fixture. The room is furnished with a brown leather sofa, a round coffee table, and several armchairs. A large, glowing geometric light fixture is suspended from the ceiling. The floor is covered in a patterned carpet. The overall aesthetic is clean and contemporary.

NEMO
LINESCAPES
SYSTEM

NEMO
LINESCAPES
SYSTEM

Made in Italy

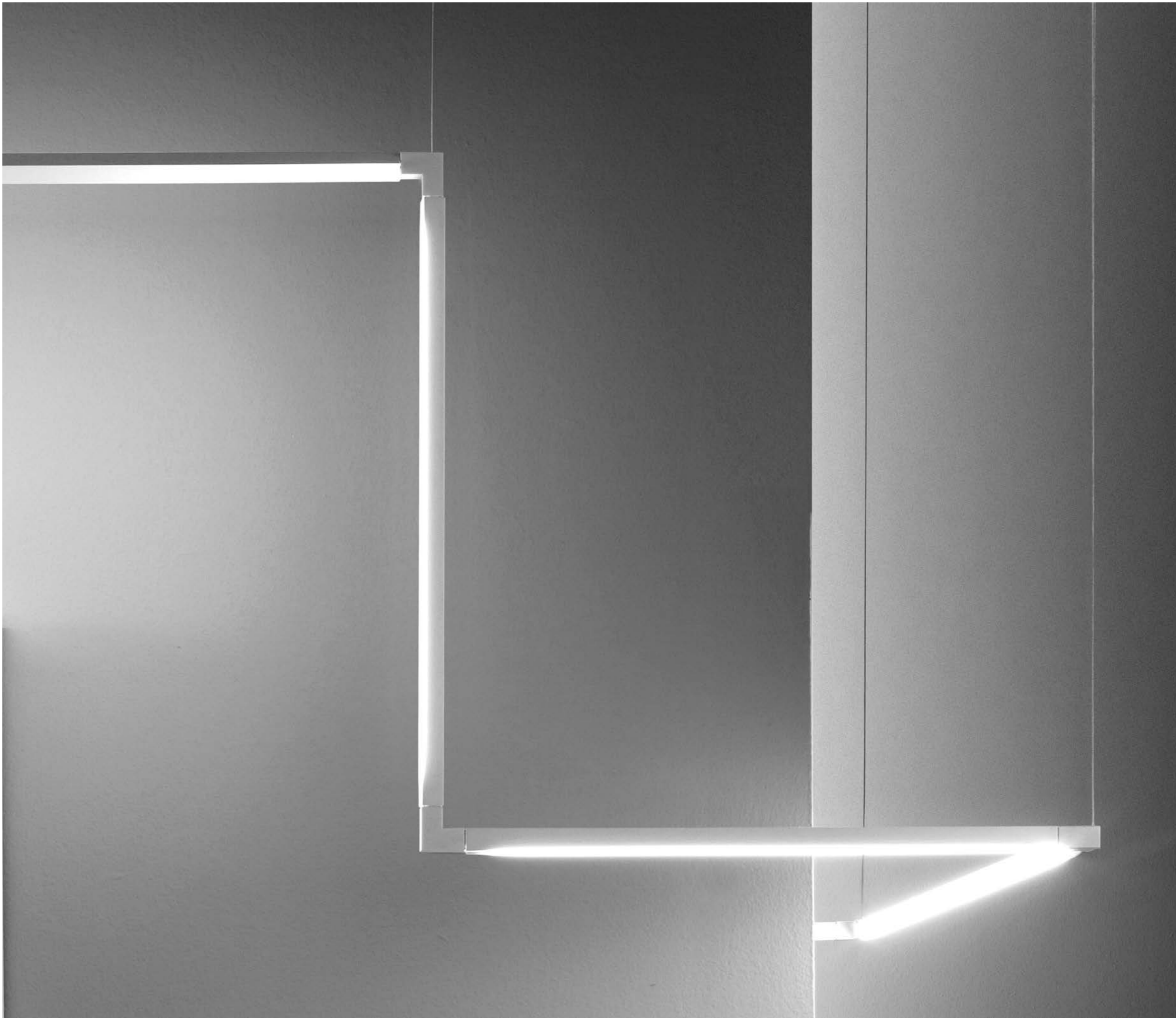

Linescapes is a modular system that is completely changing the approach to high performance diffused direct and indirect lighting. The singular modules are connected by quick ABS connectors, which enable rapid installation and a free 360° rotation.



The different elements allow the composition of continuous lines and edges, with a luminous efficiency and an excellent diffusion degree, through an opaline diffuser in polycarbonate. The system has been studied to provide user friendly maintenance. Nemo has efficiently solved the problem of replacing LED built-in sources, whereby the compromised lighting elements can be easily changed.

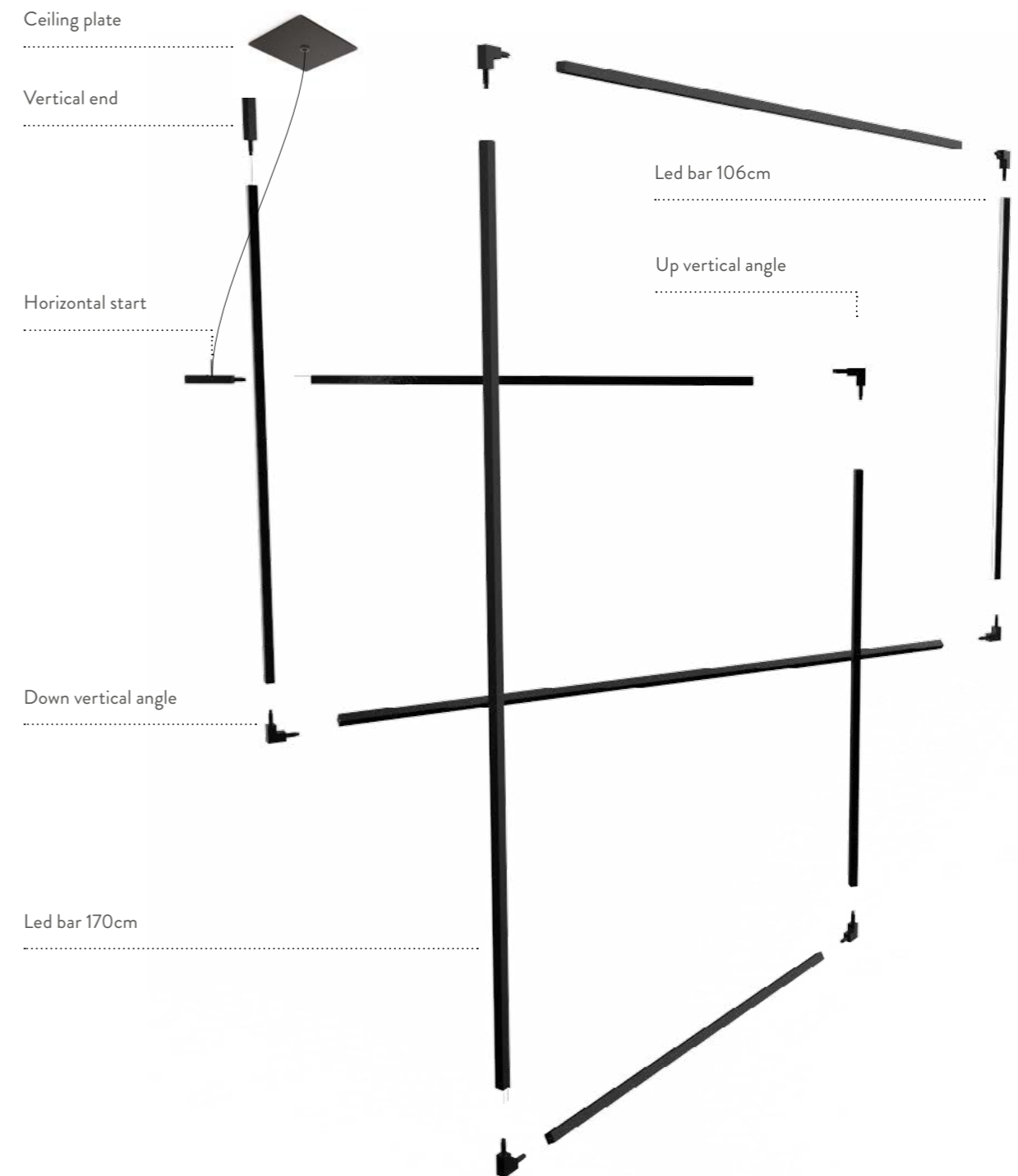





01

SEGMENT

LED - WING - LINK - SPOT

The Segment section includes three types of lighting sources, one with plain diffused LED light, another with wings that increase the visual comfort reducing the glare effect and the latter with spots for accent light. In addition, there is also a blind bar that is used only as a link.

SEGMENT | LED

Standard LED line, for a diffused light.
Aluminium body, black and white powder coated painting finish. Opal white polycarbonate diffuser with a high transmittance value.
High efficiency LED strip.

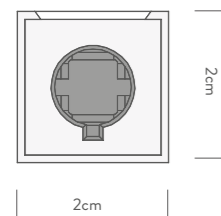
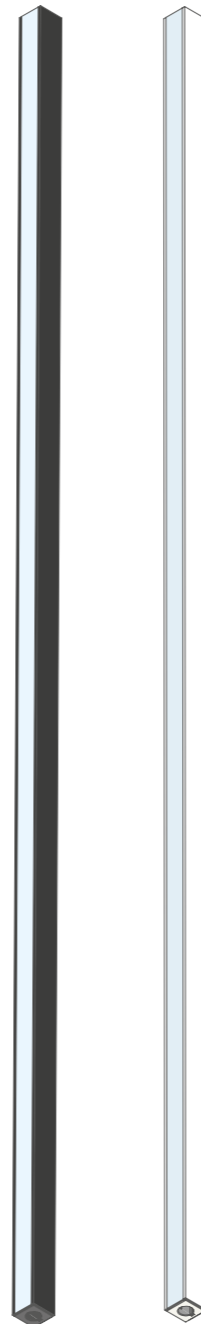

170cm / 3000K

Linear LED | diffused orientable | 33W | real flux: 2476lm
typ CRI 80 | CCT 3000K | 24V DC

- LSS LN1 51 black
- LSS LW1 51 white

170cm / 2700K

Linear LED | diffused orientable | 40W | real flux: 1490lm
typ CRI 80 | CCT 2700K | 24V DC

- LSS LN5 51 black
- LSS LW5 51 white

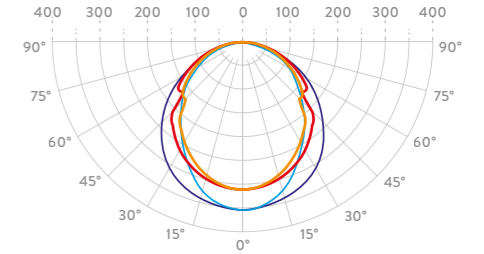

● 3000K
● 2700K

106cm / 3000K

Linear LED | diffused orientable | 19W | real flux: 1446lm
typ CRI 80 | CCT 3000K | 24V DC

- LSS LN2 51 black
- LSS LW2 51 white

106cm / 2700K

Linear LED | diffused orientable | 24W | real flux: 944lm
typ CRI 80 | CCT 2700K | 24V DC

- LSS LN6 51 black
- LSS LW6 51 white

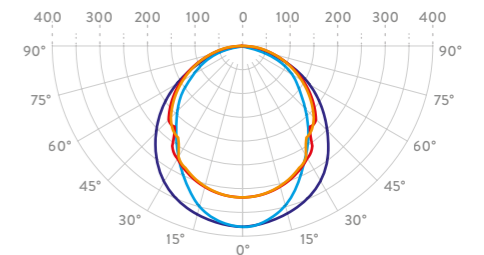
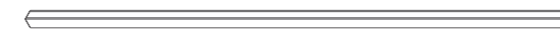

● 3000K
● 2700K

56cm / 3000K

Linear LED | diffused orientable | 9,5W | real flux: 723lm
typ CRI 80 | CCT 3000K | 24V DC

- LSS LN3 51 black
- LSS LW3 51 white

56cm / 2700K

Linear LED | diffused orientable | 12W | real flux: 472lm
typ CRI 80 | CCT 2700K | 24V DC

- LSS LN7 51 black
- LSS LW7 51 white

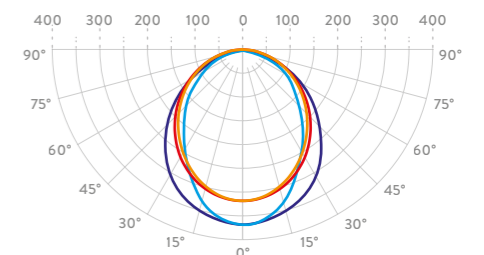

● 3000K
● 2700K

36cm / 3000K

Linear LED | diffused orientable | 6W | real flux: 430lm
typ CRI 80 | CCT 3000K | 24V DC

- LSS LN4 51 black
- LSS LW4 51 white

36cm / 2700K

Linear LED | diffused orientable | 7W | real flux: 206lm
typ CRI 80 | CCT 2700K | 24V DC

- LSS LN8 51 black
- LSS LW8 51 white

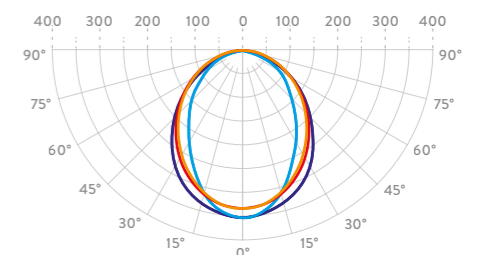

● 3000K
● 2700K

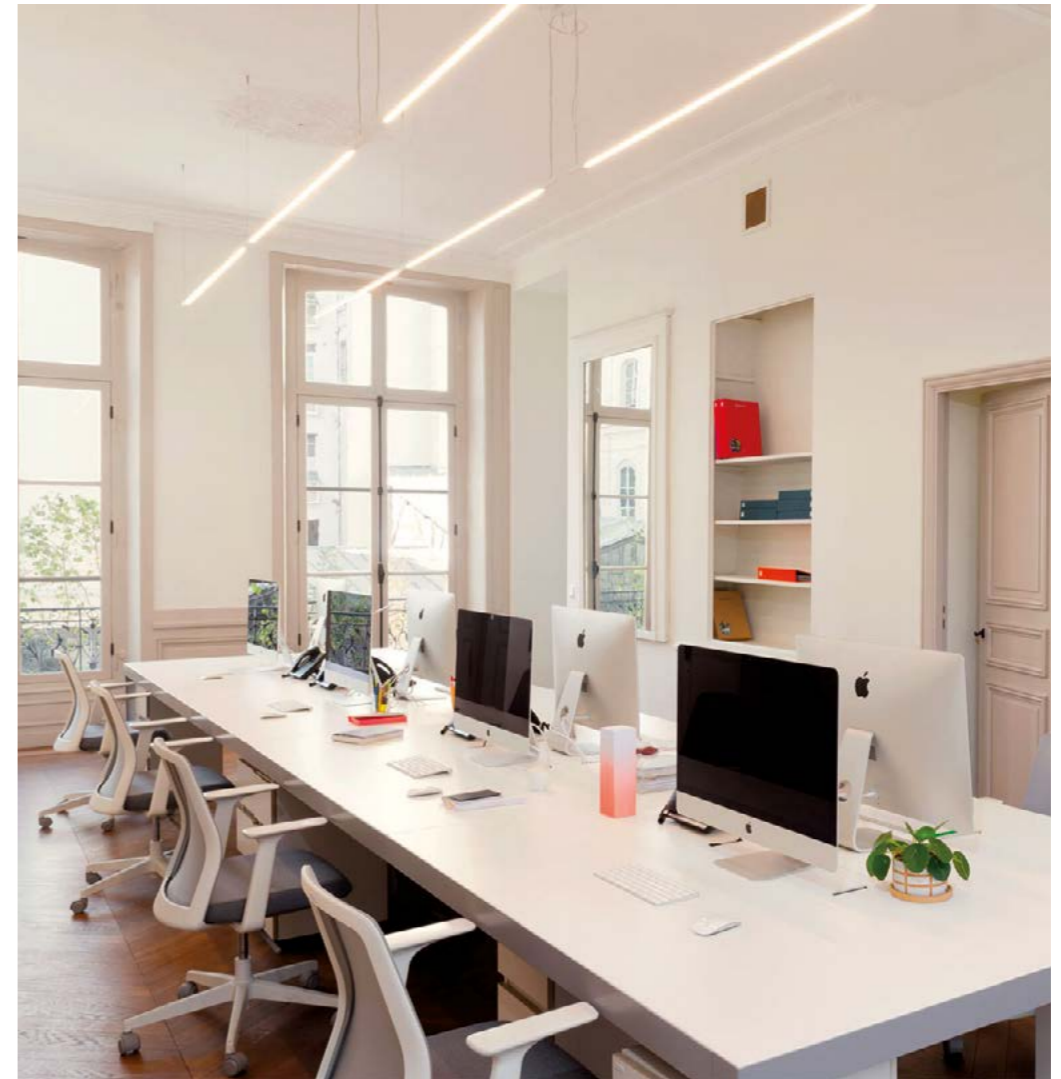

SEGMENT | WING

Custom diffuser LED bar realized in aluminium black or white painted. The diffuser, obtained by a co-extrusion of polycarbonate, has black or white wings according to the body finish. The wings help to reduce the glare and to improve the visual comfort.

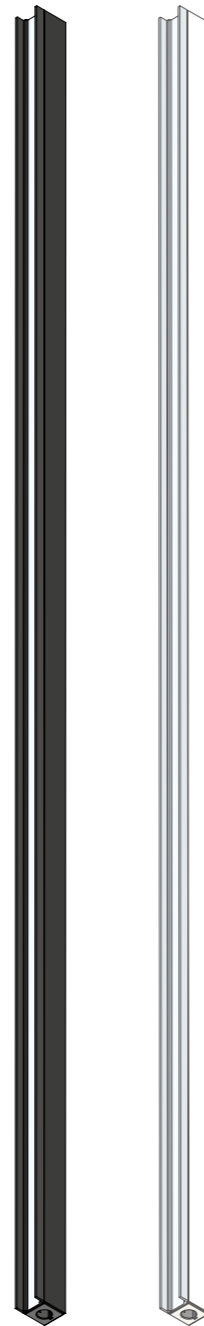
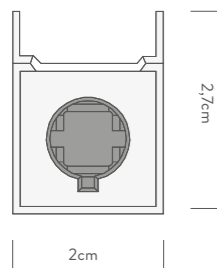

170cm / 3000K

Linear LED | diffused orientable | 33W | real flux: 2352lm
typ CRI 80 | CCT 3000K | 24V DC

- LSS UN1 51 black
- LSS UW1 51 white

170cm / 2700K

Linear LED | diffused orientable | 40W | real flux: 1490lm
typ CRI 80 | CCT 2700K | 24V DC

- LSS UN5 51 black
- LSS UW5 51 white



106cm / 3000K

Linear LED | diffused orientable | 19W | real flux: 1374lm
typ CRI 80 | CCT 3000K | 24V DC

- LSS UN2 51 black
- LSS UW2 51 white

106cm / 2700K

Linear LED | diffused orientable | 24W | real flux: 944lm
typ CRI 80 | CCT 2700K | 24V DC

- LSS UN6 51 black
- LSS UW6 51 white



56cm / 3000K

Linear LED | diffused orientable | 9,5W | real flux: 687lm
typ CRI 80 | CCT 3000K | 24V DC

- LSS UN3 51 black
- LSS UW3 51 white

56cm / 2700K

Linear LED | diffused orientable | 12W | real flux: 472lm
typ CRI 80 | CCT 2700K | 24V DC

- LSS UN7 51 black
- LSS UW7 51 white



36cm / 3000K

Linear LED | diffused orientable | 6W | real flux: 408lm
typ CRI 80 | CCT 3000K | 24V DC

- LSS UN4 51 black
- LSS UW4 51 white

36cm / 2700K

Linear LED | diffused orientable | 7W | real flux: 206lm
typ CRI 80 | CCT 2700K | 24V DC

- LSS UN8 51 black
- LSS UW8 51 white



SEGMENT | LINK

The not illuminating segment has been created to allow the creation of more articulated compositions by electrically connecting the lighting segments, obtaining different atmospheres within the same design. 20mm square section aluminium rod. Black and white finishes, available in four dimensions. Only suitable for 24V use.

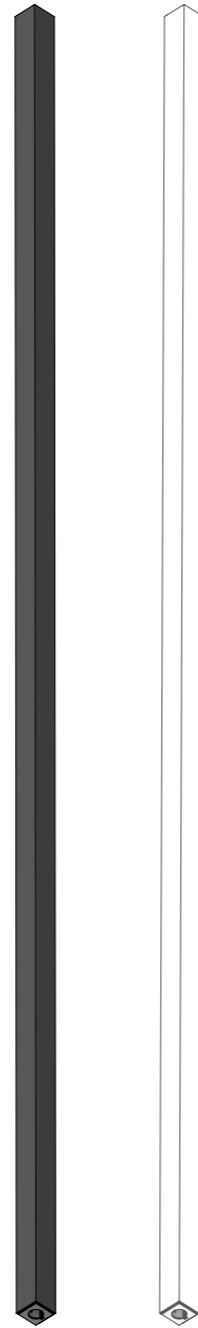
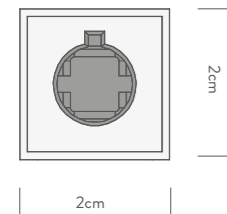

170cm

Linear CONNECTION | orientable | 24V DC

- LSS BN1 51 black
- LSS BW1 51 white

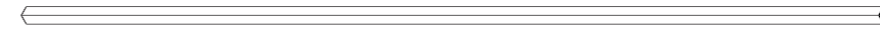

106cm

Linear CONNECTION | orientable | 24V DC

- LSS BN2 51 black
- LSS BW2 51 white



56cm

Linear CONNECTION | orientable | 24V DC

- LSS BN3 51 black
- LSS BW3 51 white

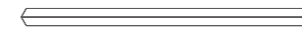

36cm

Linear CONNECTION | orientable | 24V DC

- LSS BN4 51 black
- LSS BW4 51 white



SEGMENT | SPOT

Spot modules are proposed in two sizes, 106cm with three spots and 56cm with two. Modules are proposed in black and white finishes. The spots are composed by aluminium body, a 4W star chip LED and a 15° PMMA optic. The head junction allows 90° x 340° orientation.

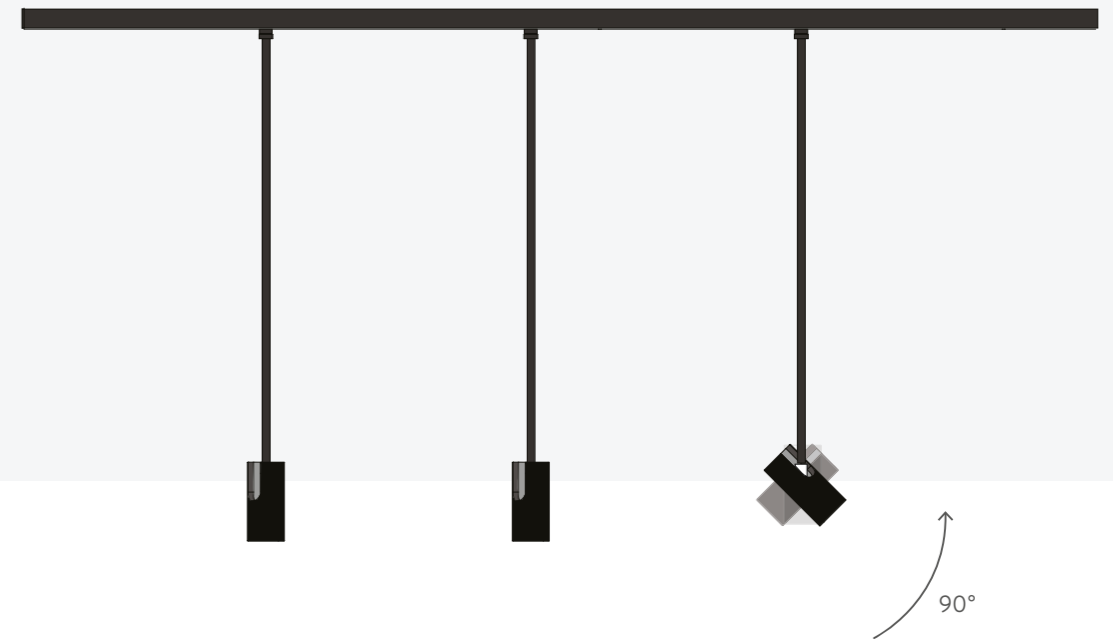
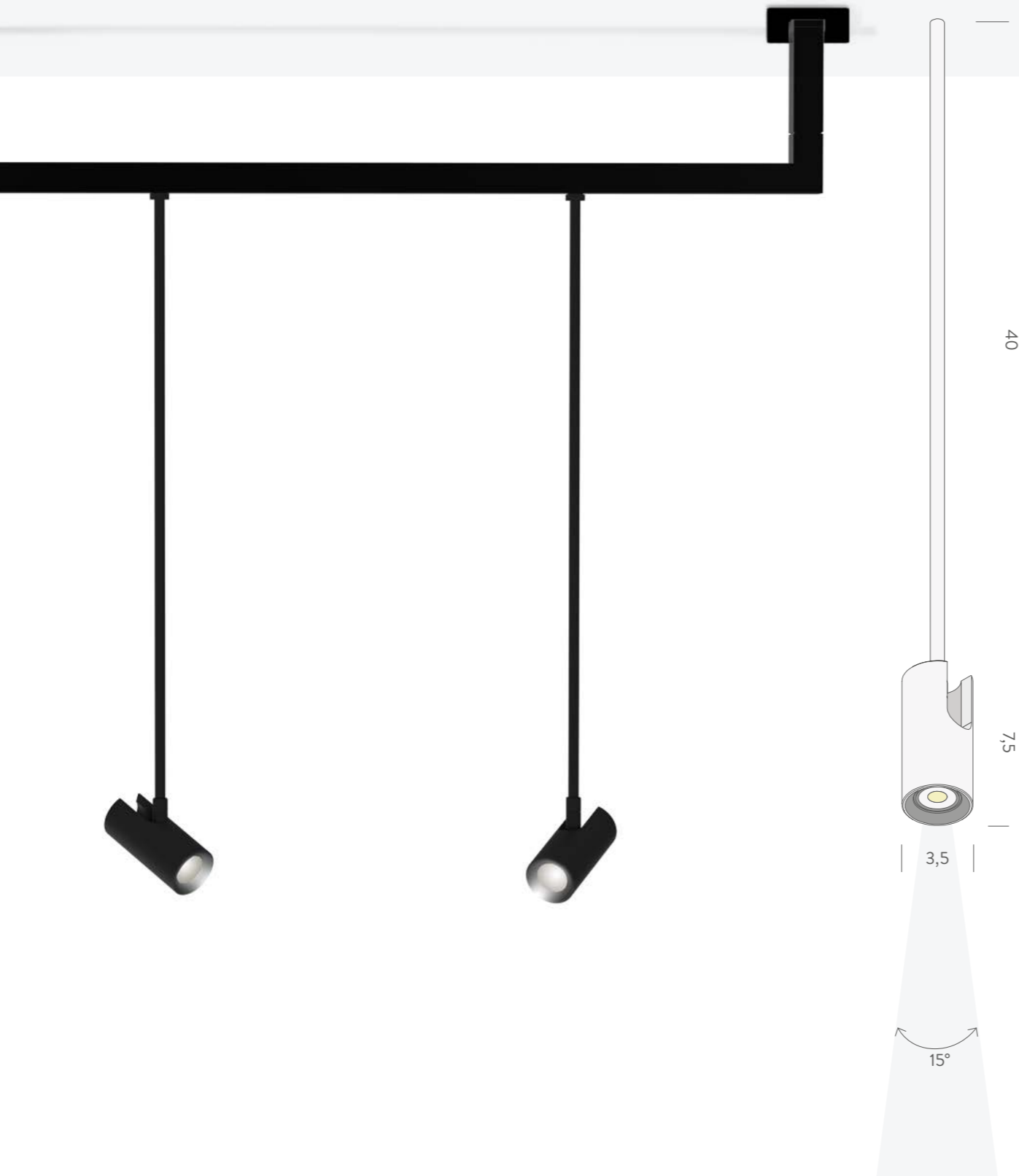

106cm
Spot LED | orientable | 3X4W | nom. flux: 3x500lm
typ CRI 90 | CCT 2700K | 24V DC

- LSS SN2 51 black
- LSS SW2 51 white

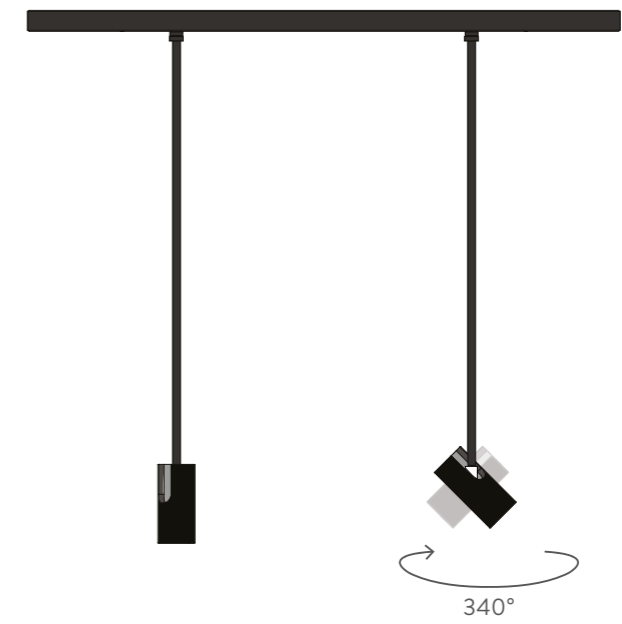

56cm
Spot LED | orientable | 2X4W | nom. flux: 2x500lm
typ CRI 90 | CCT 2700K | 24V DC

- LSS SN1 51 black
- LSS SW1 51 white

SEGMENT | SPOT



CONFIGURATION EXAMPLE

Ceiling end



Down vertical angle

Connection bar
107 cm

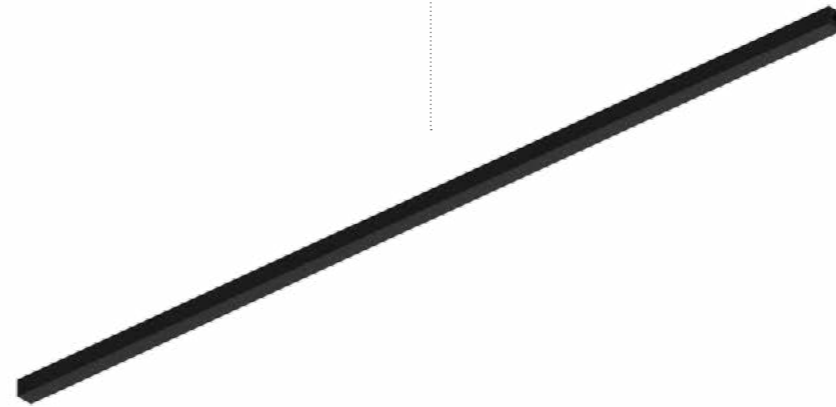

Ceiling
XYZ



Spot bar
56cm

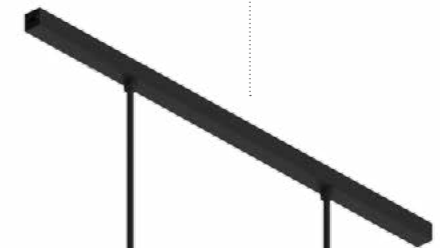

Ceiling
start



Down vertical angle



02

CONNECTION

T-SHAPE - L-SHAPE - LINEAR - WALL/CEILING

The Connection section includes four families of modules, that are able to join the segments: the L-Shape, the T-Shape, the Linear and the Wall/Ceiling fastenings.

CONNECTION | T-SHAPE

Connection elements built in PC+ABS with two or three jacks. Available in black or white liquid painted finish. Metal fixing accessories included (wire max length 3 meters).

STEEL CEILING
CABLE FIXING
cable max 3 meters

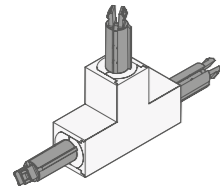

T DOWN VERTICAL

- LSS TN1 51 black
- LSS TW1 51 white

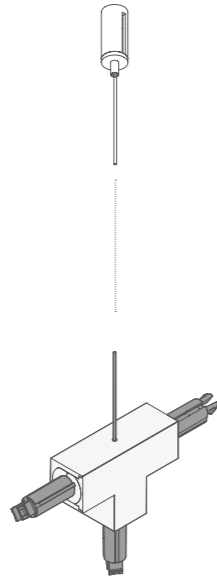

T UP VERTICAL

- LSS TN2 51 black
- LSS TW2 51 white

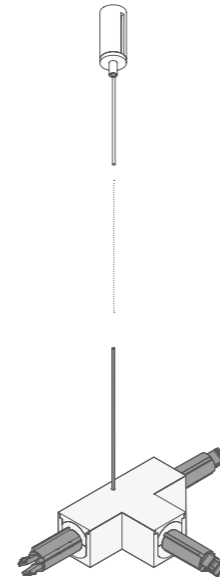

T HORIZONTAL

- LSS TN3 51 black
- LSS TW3 51 white

CONNECTION | L-SHAPE

STEEL CEILING
CABLE FIXING
cable max 3 meters

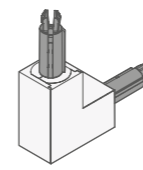

DOWN VERTICAL ANGLE

- LSS AN2 51 black
- LSS AW2 51 white

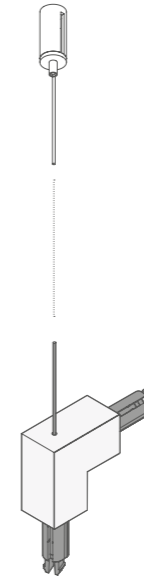

UP VERTICAL ANGLE

- LSS AN1 51 black
- LSS AW1 51 white

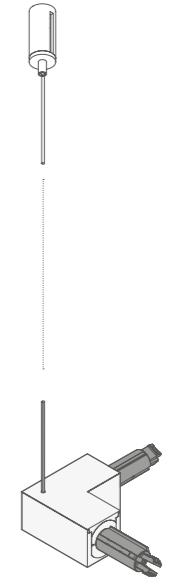

HORIZONTAL ANGLE

- LSS AN3 51 black
- LSS AW3 51 white

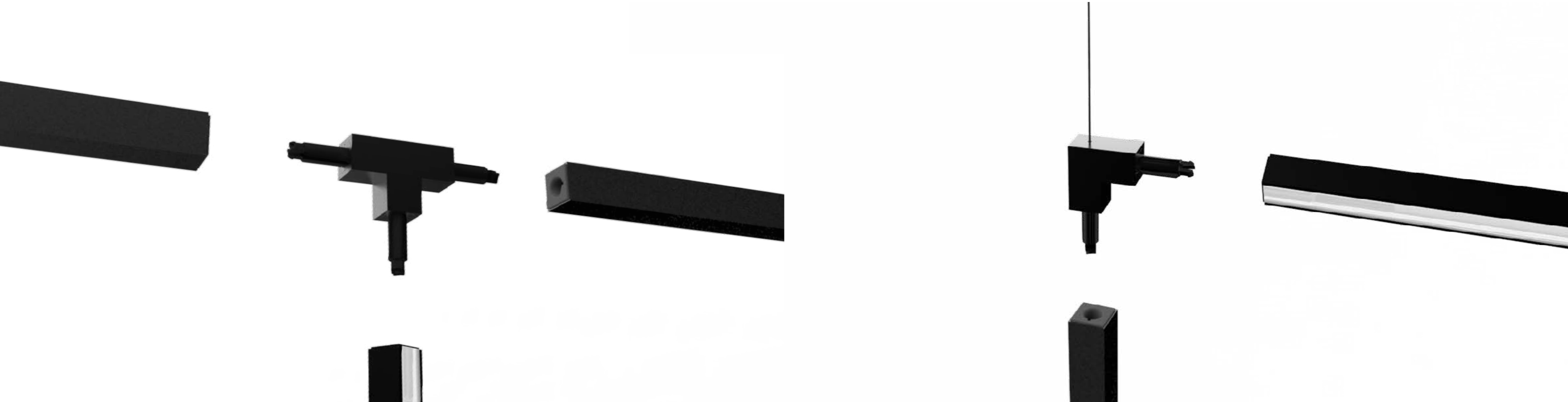



CONNECTION | LINEAR

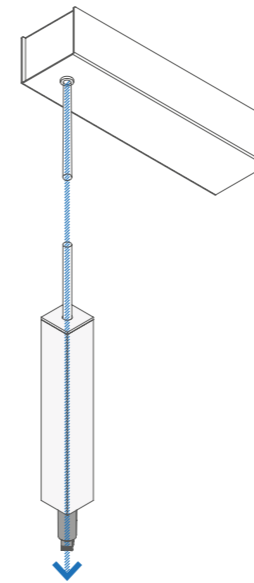

VERTICAL START

- LSS CN1 51 black
- LSS CW1 51 white

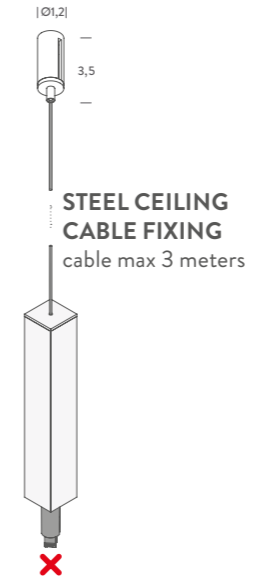

VERTICAL END

- LSS CN6 51 black
- LSS CW6 51 white

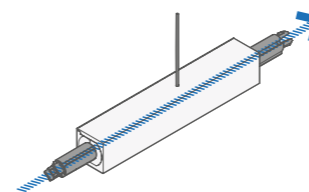

CENTRAL

- LSS CN5 51 black
- LSS CW5 51 white

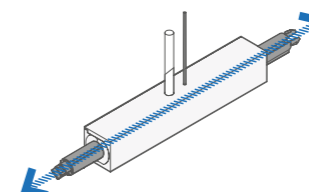

CENTRAL SUPPLY

- LSS CN4 51 black
- LSS CW4 51 white

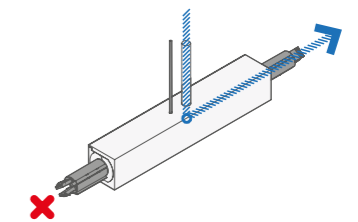

CENTRAL ONE WAY

- LSS CN7 51 black
- LSS CW7 51 white

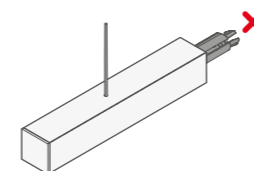

HORIZONTAL END

- LSS CN3 51 black
- LSS CW3 51 white

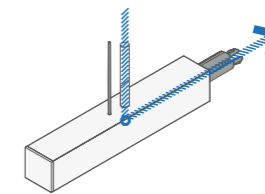

HORIZONTAL START

- LSS CN2 51 black
- LSS CW2 51 white

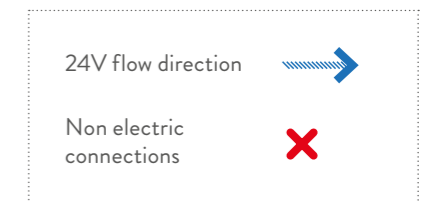

CONNECTION | WALL/CEILING END

The wall/ceiling fixing accessories are realized in painted aluminium, they allow to achieve different compositions based on the other connectors used. Start module lets the system be powered by a remote 24V source.



WALL/CEILING | END

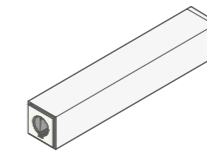

WALL/CEILING END

- LSS FN1 41 black
- LSS FW1 41 white

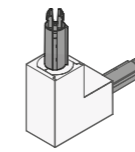

DOWN VERTICAL ANGLE

- LSS AN2 51 black
- LSS AW2 51 white

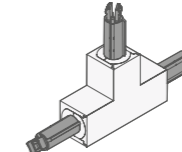

T DOWN VERTICAL

- LSS TN1 51 black
- LSS TW1 51 white

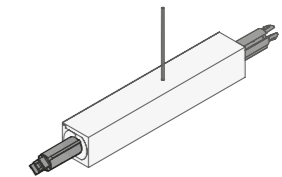

CENTRAL

- LSS CN5 51 black
- LSS CW5 51 white

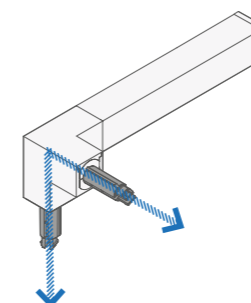
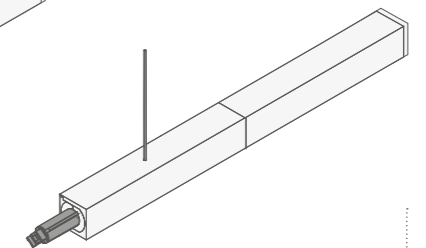
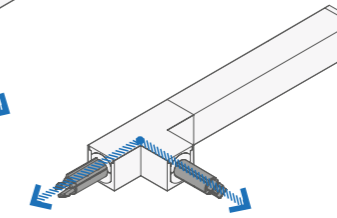
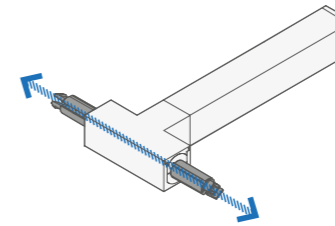
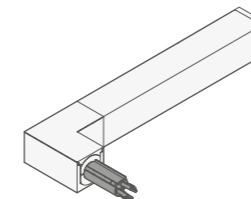

WALL/CEILING END + XYZ CONNECTOR

- LSS FN2 41 black
- LSS FW2 41 white

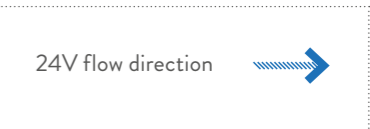

CONNECTION | WALL/CEILING START

WALL/CEILING | START

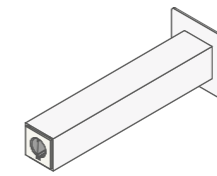
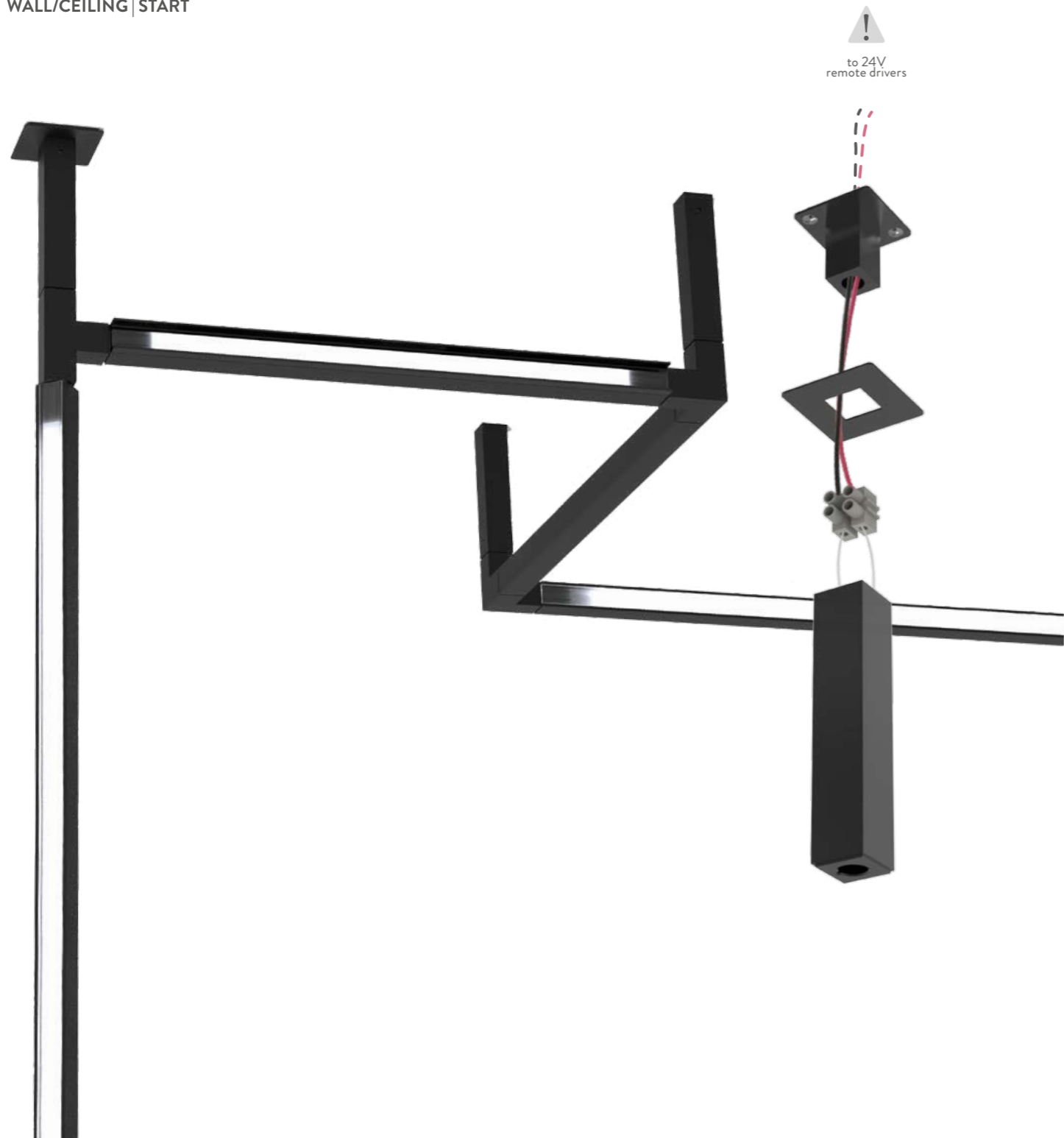

WALL/CEILING START

- LSS FN3 41 black
- LSS FW3 41 white

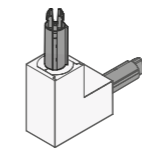

DOWN VERTICAL ANGLE

- LSS AN2 51 black
- LSS AW2 51 white

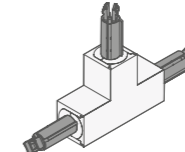

T DOWN VERTICAL

- LSS TN1 51 black
- LSS TW1 51 white

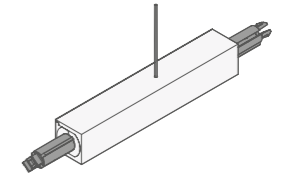

CENTRAL

- LSS CN5 51 black
- LSS CW5 51 white

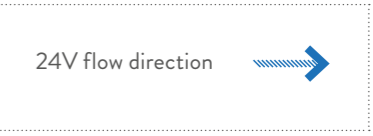
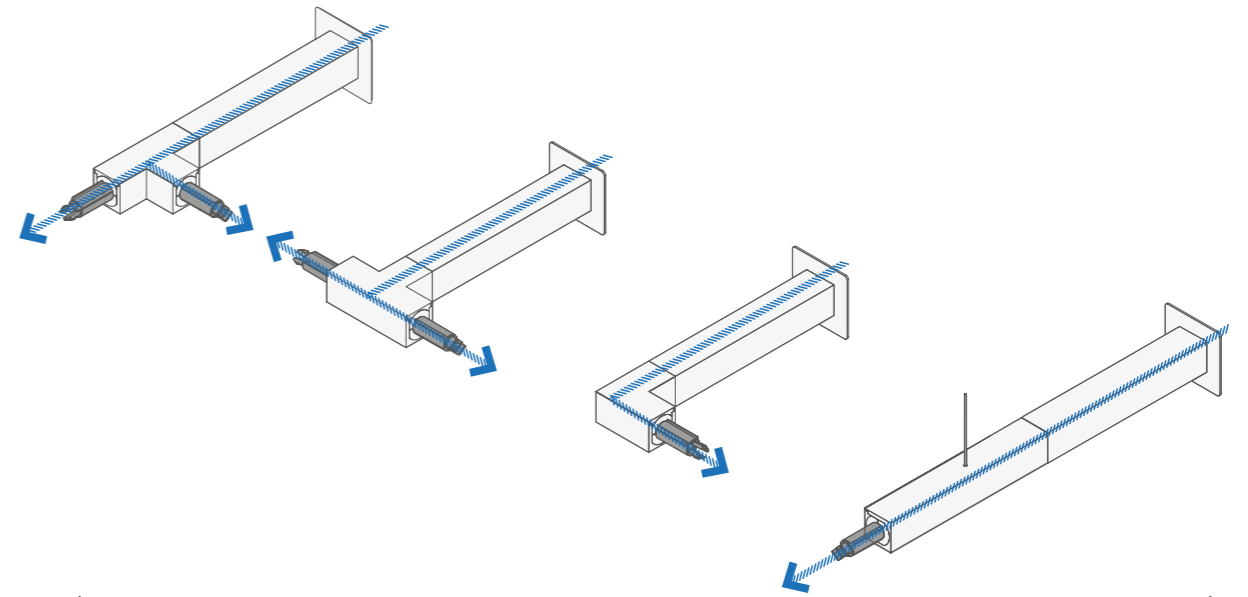

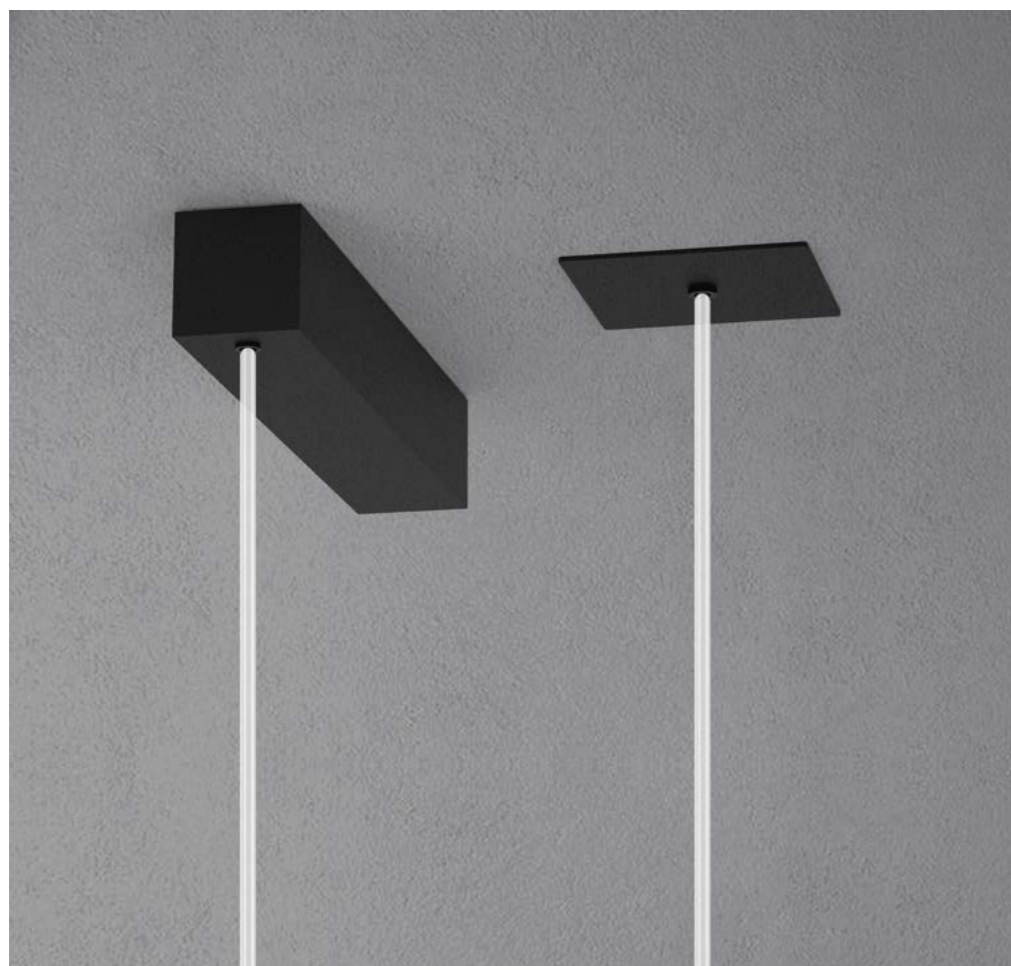

03

ACCESSORIES

BOX - CEILING PLATE - CANOPY - REMOTE

The Accessories section shows the different possibilities to link the whole system to the main current: directly with a ceiling connected power supply or with remote driver installations.

ACCESSORY | BOX

Power boxes come in two different sizes, 60W and 90W, that allow to compose 3 and 4m systems respectively. The metal boxes are painted black and white. Both the drivers are dimmable 1-10V.



60W 1-10V

- LSS PN6 51 black
- LSS PW6 51 white

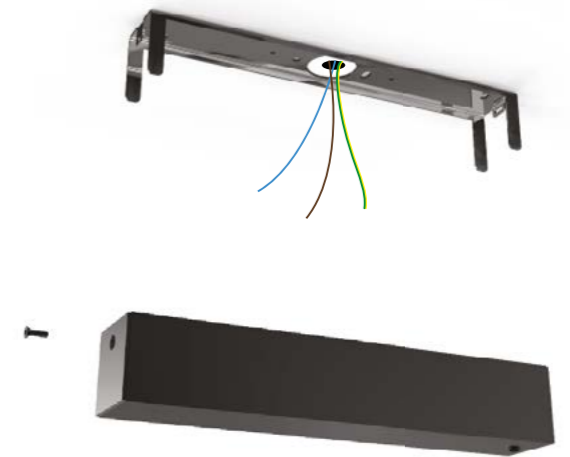
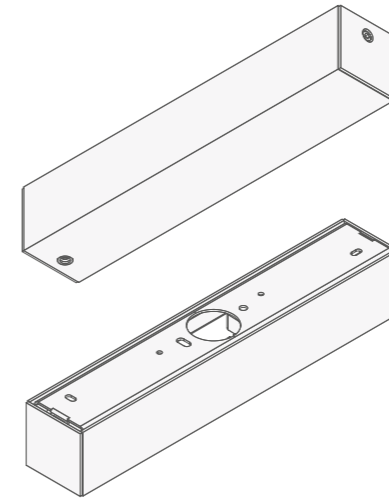

90W 1-10V

- LSS PN9 51 black
- LSS PW9 51 white

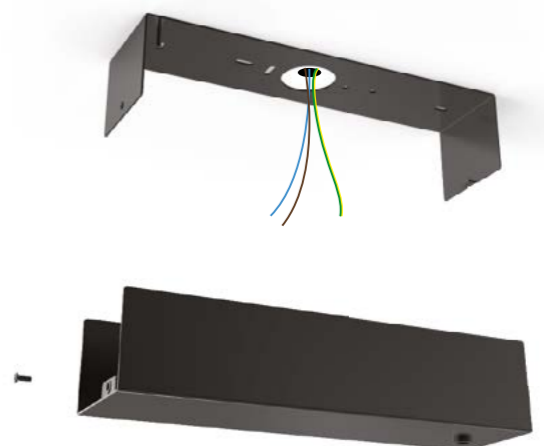
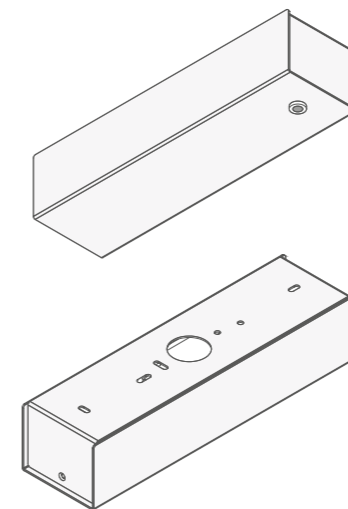



ACCESSORY | DIMMER

ON/OFF SWITCH INSTALLATION

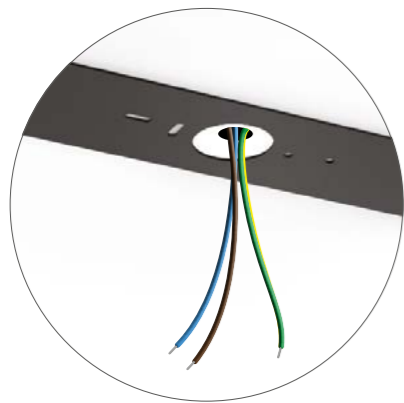

3 WIRES

LINE 

NEUTRAL 

GROUND 

1-10V DIMMING INSTALLATION

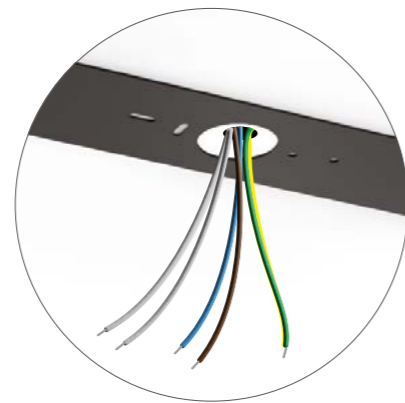

5 WIRES

LINE 

NEUTRAL 

GROUND 

1-10V | V+ 
 | V- 

ACCESSORY | REMOTE

CANOPY

PC+ABS for standard ceiling mounting and remote 24V drivers application.

- ROS KNN 51 black
- ROS KWW 51 white



CEILING PLATE

The painted metal plate is designed for false ceiling installation and remote 24V drivers supply.

- LSS PNR 51 black
- LSS PWR 51 white



ACCESSORY | REMOTE DRIVER

1-10V

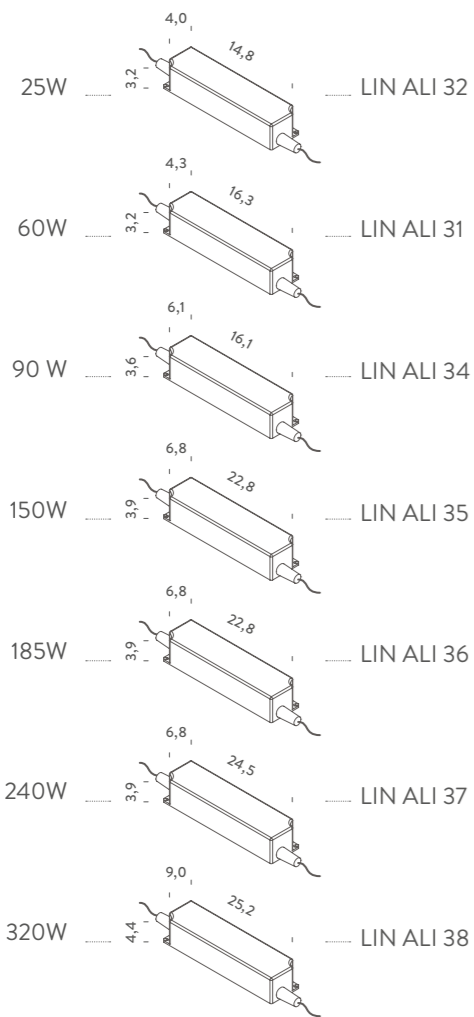

DALI

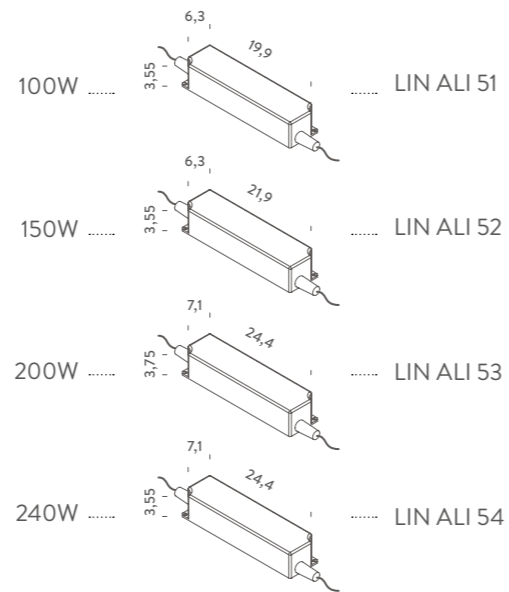

Notes:
110/230V input, 24V output, IP65
Consider an average power consumption of ~25W/m

ACCESSORY | DISPLAY BOX

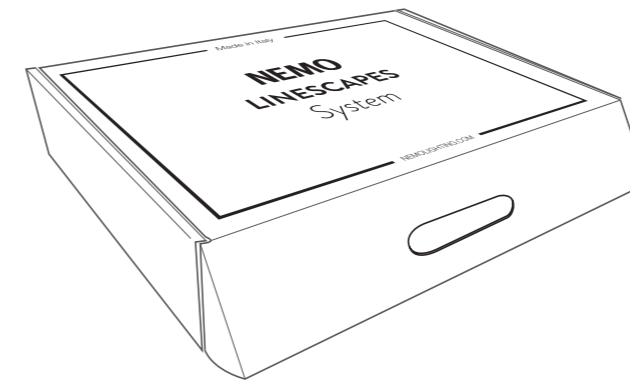

Nemo offers a presentation tool to better promote and explain the linescapes system. The box comes with two LED segments and a L-Shape connector. The set is completed by a push dimmable driver connected to a vertical start.

DISPLAY BOX

○ LSS VAL 99

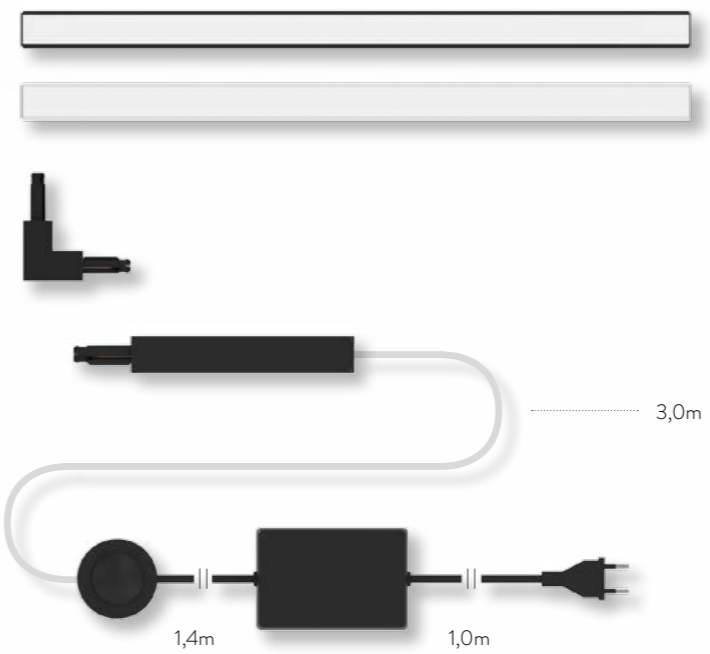

SUMMARY

LED SEGMENT

- | | | | |
|---|---|---|---|
| 170cm - 33W - 3000K
● LSS LN1 51 black
○ LSS LW1 51 white | 106cm - 19W - 3000K
● LSS LN2 51 black
○ LSS LW2 51 white | 56cm - 9,5W - 3000K
● LSS LN3 51 black
○ LSS LW3 51 white | 36cm - 6W - 3000K
● LSS LN4 51 black
○ LSS LW4 51 white |
| 170cm - 40W - 2700K
● LSS LN5 51 black
○ LSS LW5 51 white | 106cm - 24W - 2700K
● LSS LN6 51 black
○ LSS LW6 51 white | 56cm - 12W - 2700K
● LSS LN7 51 black
○ LSS LW7 51 white | 36cm - 7W - 2700K
● LSS LN8 51 black
○ LSS LW8 51 white |



WING SEGMENT

- | | | | |
|---|---|---|---|
| 170cm - 33W - 3000K
● LSS UN1 51 black
○ LSS UW1 51 white | 106cm - 19W - 3000K
● LSS UN2 51 black
○ LSS UW2 51 white | 56cm - 9,5W - 3000K
● LSS UN3 51 black
○ LSS UW3 51 white | 36cm - 6W - 3000K
● LSS UN4 51 black
○ LSS UW4 51 white |
| 170cm - 40W - 2700K
● LSS UN5 51 black
○ LSS UW5 51 white | 106cm - 24W - 2700K
● LSS UN6 51 black
○ LSS UW6 51 white | 56cm - 12W - 2700K
● LSS UN7 51 black
○ LSS UW7 51 white | 36cm - 7W - 2700K
● LSS UN8 51 black
○ LSS UW8 51 white |



CONNECTION SEGMENT

- | | | | |
|---|---|--|--|
| 170cm
● LSS BN1 51 black
○ LSS BW1 51 white | 106cm
● LSS BN2 51 black
○ LSS BW2 51 white | 56cm
● LSS BN3 51 black
○ LSS BW3 51 white | 36cm
● LSS BN4 51 black
○ LSS BW4 51 white |
|---|---|--|--|

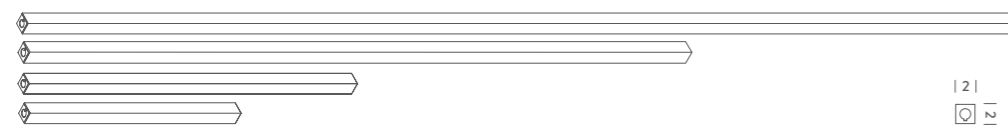

SPOT SEGMENT

- SPOT3 106cm**
● LSS SN2 51 black
○ LSS SW2 51 white

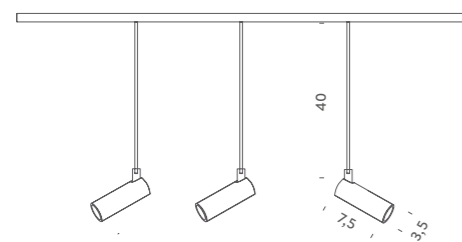

- SPOT2 56cm**
● LSS SN1 51 black
○ LSS SW1 51 white

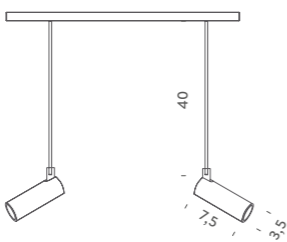

REMOTE DRIVER

1-10V

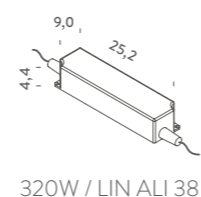
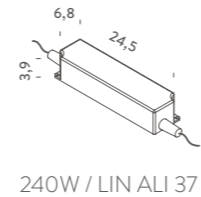
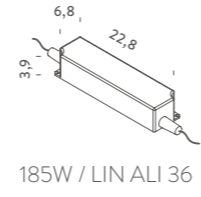
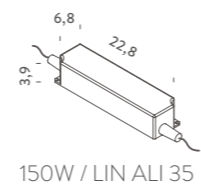
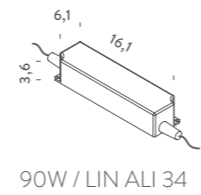
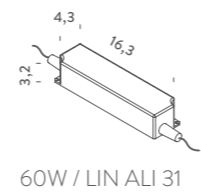
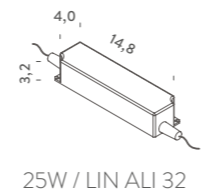

REMOTE DRIVER

DALI

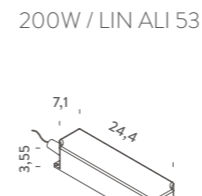
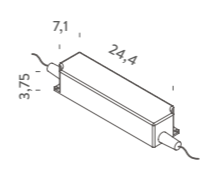
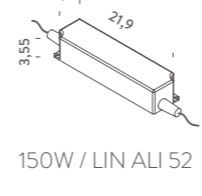
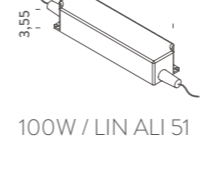

CONNECTION

T UP VERTICAL

- LSS TN2 51 black
- LSS TW2 51 white

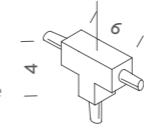

T DOWN VERTICAL

- LSS TN1 51 black
- LSS TW1 51 white

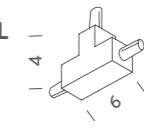

T HORIZONTAL

- LSS TN3 51 black
- LSS TW3 51 white

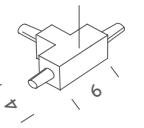

UP VERTICAL ANGLE

- LSS AN1 51 black
- LSS AW1 51 white

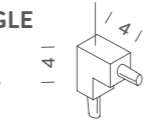

DOWN VERTICAL ANGLE

- LSS AN2 51 black
- LSS AW2 51 white

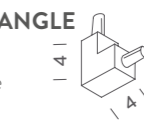

HORIZONTAL ANGLE

- LSS AN3 51 black
- LSS AW3 51 white

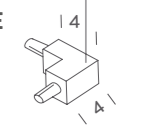

CENTRAL

- LSS CN5 51 black
- LSS CW5 51 white

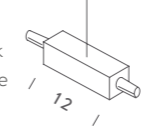

CENTRAL ONE WAY

- LSS CN7 51 black
- LSS CW7 51 white

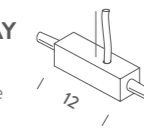

CENTRAL SUPPLY

- LSS CN4 51 black
- LSS CW4 51 white

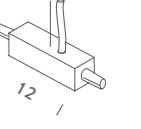

HORIZONTAL START

- LSS CN2 51 black
- LSS CW2 51 white

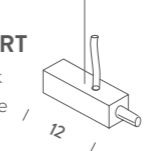

VERTICAL START

- LSS CN1 51 black
- LSS CW1 51 white

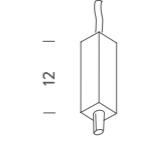

WALL CEILING START

- LSS FN3 41 black
- LSS FW3 41 white

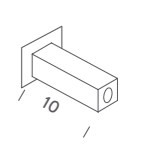

HORIZONTAL END

- LSS CN3 51 black
- LSS CW3 51 white

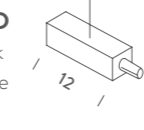

VERTICAL END

- LSS CN6 51 black
- LSS CW6 51 white

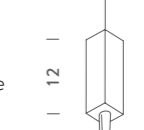

WALL CEILING END

- LSS FN1 41 black
- LSS FW1 41 white

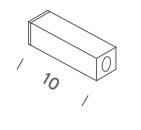

WALL CEILING END + XYZ

- LSS FN2 41 black
- LSS FW2 41 white

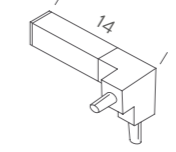

ACCESSORY

POWER SUPPLY 60W 1-10V

- LSS PN6 51 black
- LSS PW6 51 white

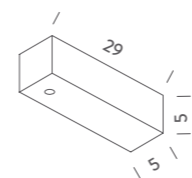

POWER SUPPLY 90W 1-10V

- LSS PN9 51 black
- LSS PW9 51 white

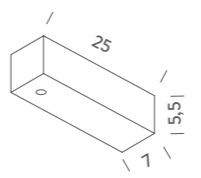

CEILING PLATE

- LSS PNR 51 black
- LSS PWR 51 white

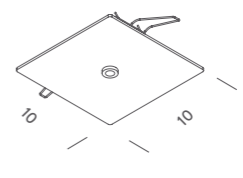

CANOPY

- ROS KNN 51 black
- ROS KWW 51 white

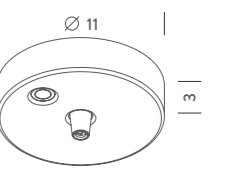

NEMO HEAD OFFICE

Viale Brianza, 30,
20823 Lentate s/S (MB) - ITALY
Tel +39 0362 166 050 0
info@nemolighting.com

NEMO GALLERY

Corso Monforte 19/A,
20122 Milan - ITALY
Tel +39 02 970 703 40
monforte@nemolighting.com

NEMO FRANCE

Zac Paris Nord II 13,
Rue de la Perdrix
BP 52352 - 95942 ROISSY
CDG Cedex - FRANCE
Tel +33 (0)1 486 300 77
france@nemolighting.fr

NEMO GALERIE PARIS

19, Rue du Bac
75007 Paris - FRANCE
Tel +33 (0) 1 40 20 47 69
ruedubac@nemolighting.fr

NEMO USA

625 Jersey Avenue, Unit 7
New Brunswick, NJ 08901 - USA
Tel 800 734 585 8
usa@nemolighting.com
nemolighting.com/us

NEMOLIGHTING.COM

NEMO products are designed and manufactured in compliance with EN 60598-1 norms. Dimensions are indicated in centimeters.

Dimensions of products made with deformations of extrusions could be subject to changes of ± 1 cm.

NEMO reserves the right to make any technical or formal alterations to its products without giving prior notice, especially for LED sources and the Segment light data.

Information concerning luminous flux/ power consumption are expressed in nominal values. Effective data are indicated in the technical sheets available on the website.

WARRANTY Conditions are indicated in the instruction sheets. Use only compatible 24V LED drivers, breakage due to the use of non-compliant parts is cause of invalidating the warranty cover.

In case of discrepancy between the information contained in the printed materials and the website, this latter shall prevail.

ART DIRECTION

Valentina Folli

PHOTOS

Alexander Böhle Photo Production,
Andrea Fongo (cover), Claude Weber,
Cube Photo Production, Yannick
Labrousse

PRINTED: OCTOBER 2018

*This document supersedes and updates
all previous catalogues and publications
in relation to the products listed here in.*

